

# Size 15 HaroMax

**Harowe™ brand**

## Heavy Duty Brushless Resolvers

### Key Features

- Frameless size 15 Servo Mounting
- Anodized Aluminum Housing with Low Mass
- Machine Wound Stator for High Accuracy

Determine resolver required characteristics from this guide. Use color-keyed diagram below, in conjunction with tables on following pages, to select part number. Please review PDF for part number selected before ordering.

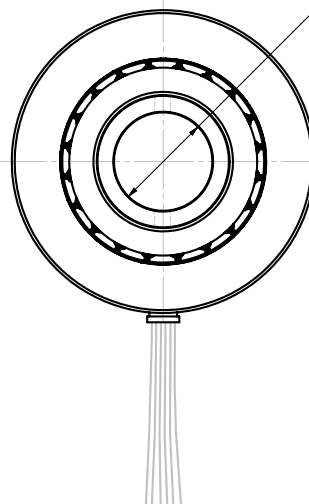
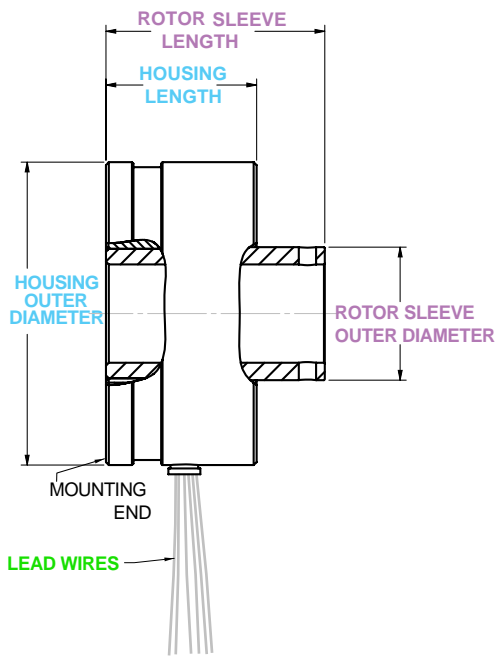

ROTOR SLEEVE INNER DIAMETER

LEAD WIRES

**PHASING**

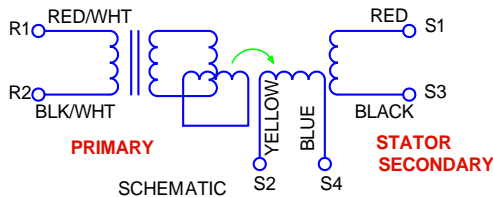

ELECTRICAL & MECHANICAL DATA AT 25°C		
VALUES ARE REFERENCE UNLESS OTHERWISE TOLERANCED		
HIPOT TESTING PERFORMED AT 60HZ, 4 SECOND DURATION		
ELEC CYC / MECH CYC	deg/deg	-
EXCITATION FREQUENCY	±1% kHz	-
INPUT VOLTAGE	±5% V rms	-
INPUT CURRENT	Max. mA rms	-
INPUT POWER	Watts	-
IMPEDANCE ZRO	Ohms	-
IMPEDANCE ZRS	Ohms	-
IMPEDANCE ZSO	Ohms	-
IMPEDANCE ZSS	Ohms	-
TRANSFORMATION RATIO	Min. to Max.	-
DC RESISTANCE (R1-R2)	Ohms	-
DC RESISTANCE (S1-S3, S2-S4)	Ohms	-
ERROR	±Max. arcminutes	-
PK-PK POSITION ERROR	Max. arcminutes	-
PK-PK VELOCITY ERROR	Max. %	-
PHASE SHIFT, OPEN CIRCUIT	degrees	-
NULL VOLTAGE	Max. mV rms	-
HIPOT, LEADS TO CASE, 500VAC	Max. mA rms	-
HIPOT, INTERPHASE, 250VAC	Max. mA rms	-
TEMPERATURE RANGE	°C	-
WEIGHT	oz	-
CONTINUOUS SPEED	Max. kRPM	-



Headquarters: 1675 Delany Road • Gurnee, IL 60031-1282 • USA

**Customer Service:**  
 Tel.: +1.800.873.8731  
 Fax: +1.847.662.4150  
 custserv@dynapar.com

**European Sales Representative**  
 Hengstler GmbH  
 Uhlandstrasse 49, 78554 Aldingen  
 Germany  
 www.hengstler.com

# Size 15 HaroMax

**Harowe™ brand**

**15** **BRX** - **700** - **B** **04** **/AB**

FRAME SIZE	
<b>15</b>	Basic OD is 1.5 inches

SYSTEM TYPE	
<b>BRX</b>	Single speed - Rotor Primary

TYPE	HOUSING MOUNT-MATERIAL-LENGTH-PILOT
<b>700</b>	Single Servo Groove - Aluminum - 0.635 inch long with 1.449 inch pilot

Code	Type	Input Excitation				Phase Shift	Zro Ohm	Zso Ohm	Rotor Ohm	Stator Ohm	Null mv	Speed
		Vrms	KHz	mA	TR							
<b>B</b>	BRX	2	10	50	0.98	+10	50	810	23	116	30	1
Except- <b>B04AB</b>		5	10	20	0.42	-8	295	820	60	116	20	1
<b>D</b>	BRX	8	8	50	0.50	0	182	627	55	116	30	1
<b>F</b>	BRX	4	5	45	0.50	1.5	129	461	23	116	20	1

CODE	ROTOR BORE	LENGTH
<b>4</b>	3/8 inch	1 inch
<b>10</b>	3/8 inch	0.635 inch
<b>14</b>	3/8 inch w/flat	0.635 inch

P/N	ERROR			Phasing	LEADS		Special Features	Weight Oz
	Pk-Pk arc-min	+/- %	velocity %		AWG	Inch		
15BRX700-B04AB	20	X	X	CCW	28	40	X	67g
15BRX700-B10AA	20	X	2.40	CW	28	2	X	2.11
15BRX700-D10AA	16	X	2.50	CW	28	12	X	2.11
15BRX700-D10AC	16	X	2.50	CW	Cable	24	X	2.11
15BRX700-D10AD	16	X	2.50	CW	28	4	X	2.11
15BRX700-D10AE	16	X	2.50	CW	Cable	20	X	2.11
15BRX700-D10AF	16	X	2.50	CW	Cable	64	X	58g
15BRX700-D10AF	16	X	2.50	CW	Cable	64	X	2.11
15BRX700-D10AG	16	X	2.50	CW	Cable	45	X	58g
15BRX700-D10AH	16	X	2.50	CW	Cable	125	X	2.11
15BRX700-D10AJ	16	X	2.50	CW	Cable	45	X	2.11
15BRX700-D10AK	16	X	2.50	CW	Cable	124	X	58g
15BRX700-D10AL	16	X	2.50	CW	28	6	X	2.11
15BRX700-D14AA	16	X	2.50	CW	28	300mm	X	37g
15BRX700-F10AA	20	X	X	CCW	28	12	X	65g